

Setting up a C Programming Environment for the 68HC11/12 using GNU C

Step 1: from the GNU website(http://www.gnu.org/software/m68hc11/m68hc11_pkg_zip.html) download the latest (non ALPHA) EXE version of the program.

Step 2: install to the default directory (/usr)

Step 3: Download the latest GEL library (as .zip) from <http://gel.sourceforge.net/download.php>

Step 4: Open the .zip file, open the first directory (gel-hc1x-version.zip). Highlight all the files in that directory and copy them to the /usr directory (overlying these files on the pre-existing files from the GNU install in step 2). You will get a window:

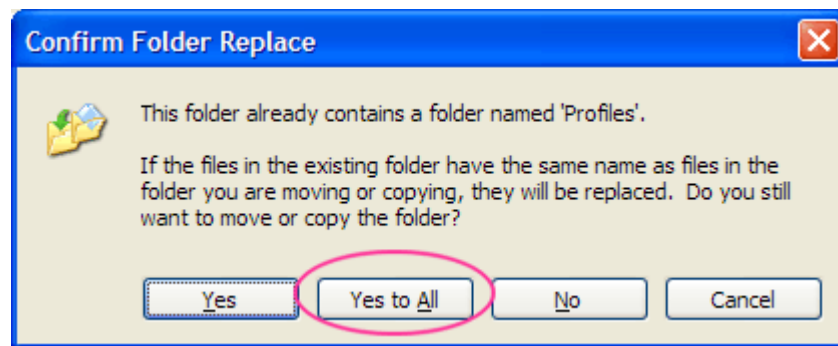

Click on “YES TO ALL”.

Step 5: Goto <http://www.ericengler.com/Embeddedgnu.aspx> and download egnu110.zip file (link almost at the bottom of the page).

Step 7: Create a directory /Embeddedgnu

Step 8: Extract all files to the directory /Embeddedgnu

Step 9: Create a **shortcut** on the desktop for the EmbeddedGNU.exe file